

3 BEDROOMS INTERIOR SE

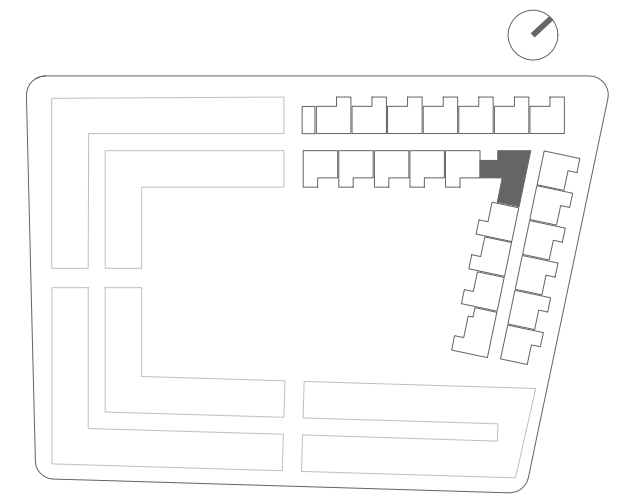

| VIVIENDA 3 dormitorios / HOUSING 3 bedrooms | (m ²) |
|---|-------------------|
| SUPERFICIES ÚTILES / USABLE AREA | 99,49 |
| TERRAZA/ TERRACE | 21,39 |
| TOTAL SUP CONSTRUIDA / TOTAL GROSS AREA | 151,28 |
| SOLARIUM | 123,02 |
| SUPERFICIE TOTAL / TOTAL AREA | 274,30 |

Plano sujeto a posibles modificaciones por razones o exigencias de índole técnica y jurídica
 Plans sujetos to possible modifications for technical or legal reasons